

JEFFERSON COUNTY, TENNESSEE
BOARD OF COMMISSIONERS

RESOLUTION 2022-24

A RESOLUTION AMENDING THE "ZONING MAP OF
JEFFERSON COUNTY, TENNESSEE" BY REZONING
PROPERTY FROM A-1, AGRICULTURAL-FORESTRY
TO C-2, GENERAL COMMERCIAL

WHEREAS, the Jefferson County Board of Commissioners, in accordance with Section 13-7-105 of the Tennessee Code Annotated, may amend the zoning resolution and the "Zoning Map of Jefferson County, Tennessee"; and

WHEREAS, the Jefferson County Regional Planning Commission has reviewed and made a recommendation regarding the proposed amendment of the "Zoning Map of Jefferson County, Tennessee."

NOW, THEREFORE, BE IT RESOLVED by the Board of County Commissioners of Jefferson County, Tennessee:

Section 1. The "Zoning Map of Jefferson County, Tennessee" is hereby amended by rezoning parcel 089.03 of Jefferson County Tax Map 039 as depicted on the attached map, from to A-1, Agricultural Forestry to C-2, General Commercial.

Section 2. The property to be rezoned is located on 3307 Old Airport Road in White Pine, TN, and is owned by Velma L. Samples.

Section 3. This resolution shall become effective from and after its passage, the public welfare requiring it.

Approved by the White Pine Regional Planning Commission, April 19, 2022.

Public hearing held: July 11, 2022.

Votes: 15 3 1 2
 Yes No Abstain Absent

Attest: Frank C. Herndon Date: 7/19/22
Frank C. Herndon - County Clerk

Approved: Mark Potts Date: 7/19/22
Mark Potts - Jefferson County Mayor

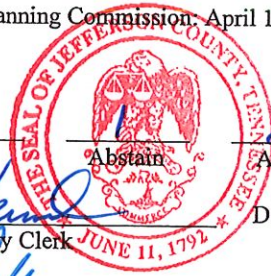

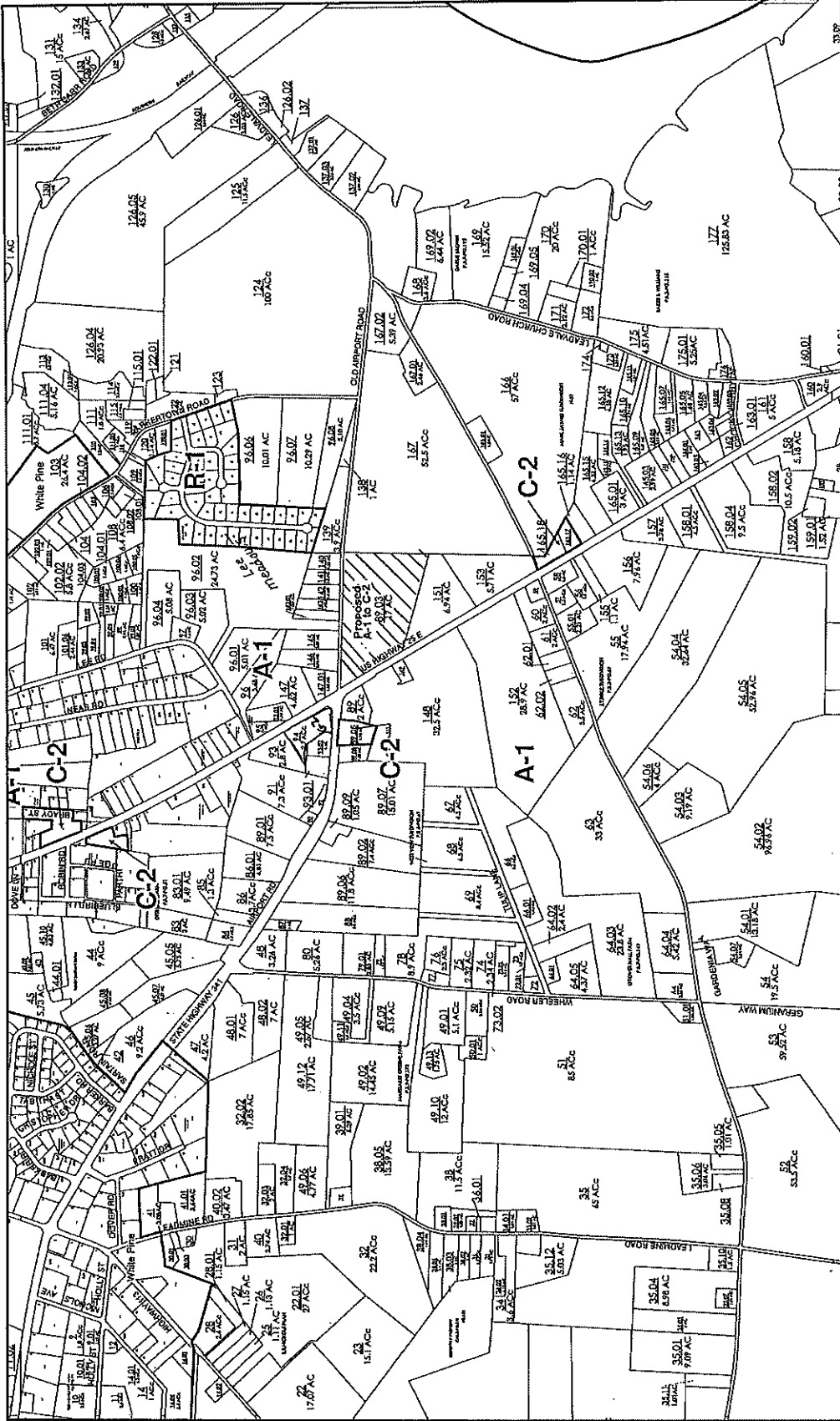

- Legend**
- A-1 Agricultural - Forestry
 - R-1 Rural Residential
 - R-2 High Density Residential
 - C-1 Neighborhood Commercial
 - C-2 General Commercial
 - I-1 Industrial
 - I-2 Environmental Industrial
 - R-R Rural Resort
 - ⊠ Incorporated Area

ZONING MAP
JEFFERSON COUNTY, TENNESSEE
 ATLAS TILE: 039

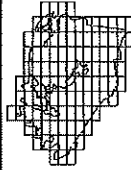

Map Prepared by:
 Department of Economic and Community
 Development
 Local Planning Assistance Office
 Geographic Information Systems
 Knoxville, TN

