

JEFFERSON COUNTY, TENNESSEE  
BOARD OF COMMISSIONERS

RESOLUTION 2022-27

A RESOLUTION AMENDING THE "ZONING MAP OF  
JEFFERSON COUNTY, TENNESSEE" BY REZONING  
PROPERTY FROM A-1, AGRICULTURAL-FORESTRY  
TO I-1, INDUSTRIAL

WHEREAS, the Jefferson County Board of Commissioners, in accordance with Section 13-7-105 of the Tennessee Code Annotated, may amend the zoning resolution and the "Zoning Map of Jefferson County, Tennessee"; and

WHEREAS, the Jefferson County Regional Planning Commission has reviewed and made a recommendation regarding the proposed amendment of the "Zoning Map of Jefferson County, Tennessee."

NOW, THEREFORE, BE IT RESOLVED by the Board of County Commissioners of Jefferson County, Tennessee:

Section 1. The "Zoning Map of Jefferson County, Tennessee" is hereby amended by rezoning a portion of parcel 029.00 of Jefferson County Tax Map 032 as depicted on the attached map, from to A-1, Agricultural Forestry to I-1, Industrial.

Section 2. The property to be rezoned is located on Highway 11-E / Whitaker Road in New Market, TN, and is owned by Betty F. Mullins, Trustee.

Section 3. This resolution shall become effective from and after its passage, the public welfare requiring it.

Approved by the Jefferson County Regional Planning Commission: May 24, 2022.

Public hearing held: July 11, 2022.

Votes:            13            5            1            2  
                         Yes            No            Abstain            Absent

Attest: Frank C. Herndon            Date: 7/19/22  
Frank C. Herndon – County Clerk

Approved: Mark Potts            Date: 7/19/22  
Mark Potts – Jefferson County Mayor



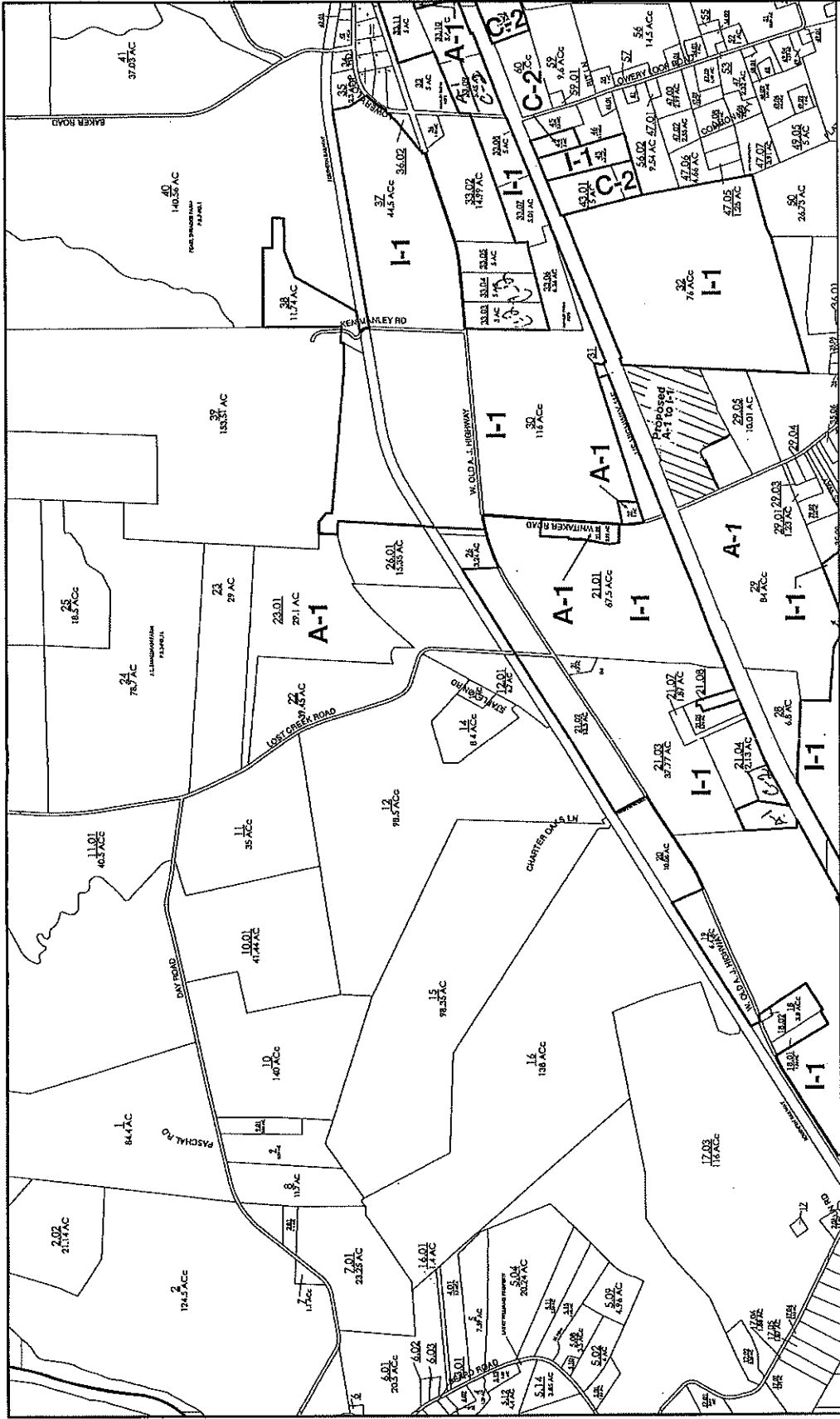

- Legend**
- C-1 Neighborhood Commercial
  - C-2 General Commercial
  - I-1 Industrial
  - I-2 Environmental Industrial
  - R-1 Rural Residential
  - R-2 High Density Residential
  - R-R Rural Resort
  - ☐ Incorporated Area

**ZONING MAP**  
**JEFFERSON COUNTY, TENNESSEE**  
 ATLAS TILE: 032



Map Prepared by:  
 Department of Economic and Community  
 Development  
 Local Planning Assistance Office  
 Geographic Information Systems  
 Knoxville, TN



500 250 0 500 Feet